

## BXM Airport Guide

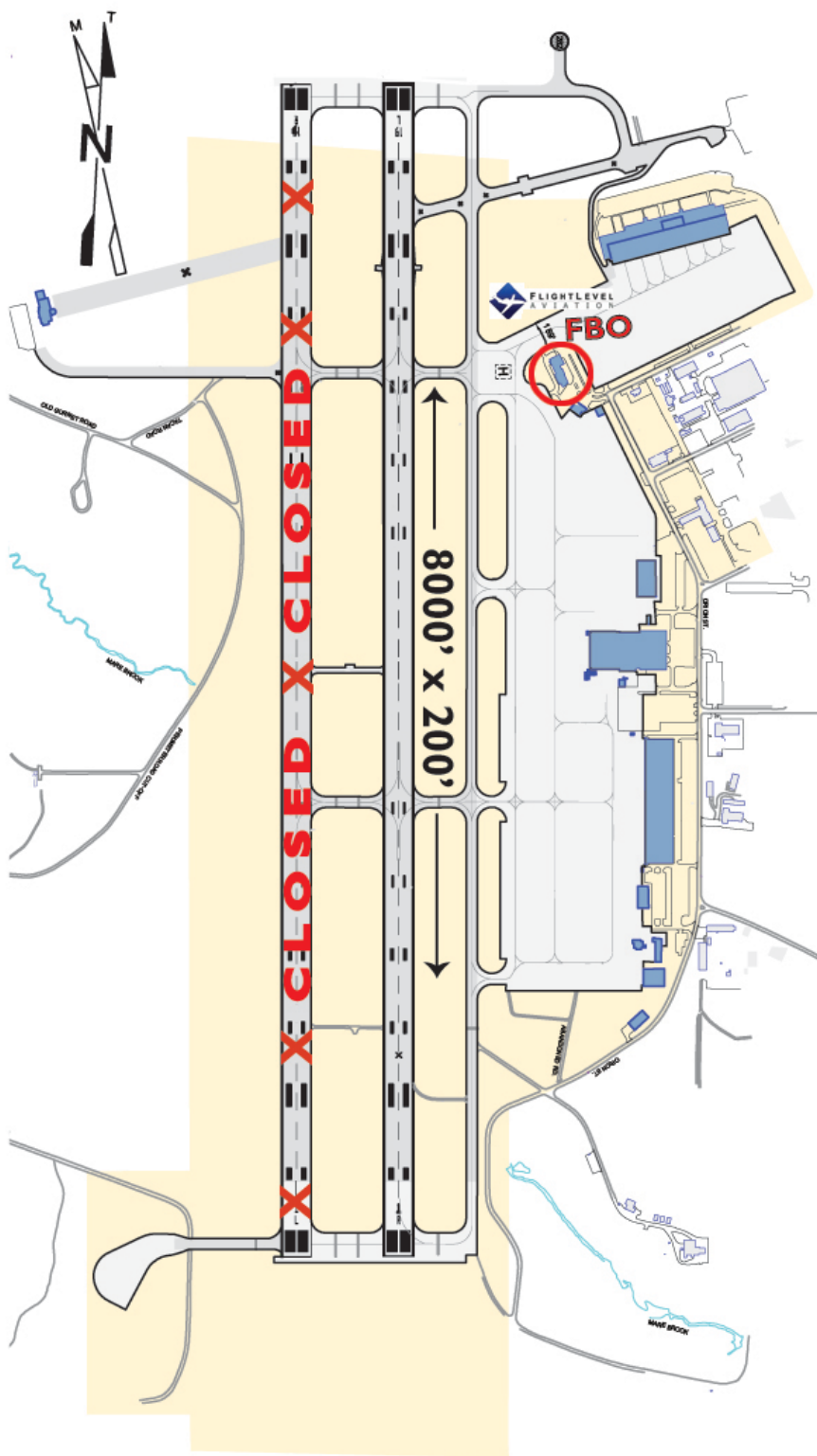

**BXM Location:** 2 SE from the town of Brunswick, ME

**Time Conversion:** UTC -5(-4DT)

**Airport Reference Pt:** N 43 -53' -32.0 | W 69 -56' -19.01

**Chart:** New York

**Instrument Approach Procedures:** ILS RWY 1R, RNAV (GPS) RWY 1R and RWY 19L

**Elevation:** 23m (75') highest elevation

**Fuel:** 100LL, Jet A

**Traffic Pattern Altitude:** 1100 (1025)

**NOTAM:** File BXM

**FAA inspection:** Not insp

**RWY 1R & 19L:** Hard Surface 8000x200(ASPH-CONC)

**RWY 1L & 19R:** CLOSED

**Class:** E **Communications:** Unicom 122.725

**Lighting:** HIRLS

**ARTCC:** BOSTON CENTER

**FSS:** BANGOR FLIGHT SERVICE STATION

**FBO:** FlightLevel Aviation – 207.406.2081

### Airport Remarks:

Right Traffic 01R/Left Traffic 19L. Runways 01L and 19R closed until further notice. Pilot controlled lighting via the Unicom. FBO services on northeast side of airport at Hangar 6. Bird activity in the vicinity of the airport

### Nearby airports with instrument procedures and weather information:

[KIWI](#) - Wiscasset Airport (11 nm NE)

[KLEW](#) - Auburn/Lewiston Municipal Airport (18 nm NW)

[KPWM](#) - Portland International Jetport (22 nm SW)

[KAUG](#) - Augusta State Airport (26 nm N)

[81B](#) - Oxford County Regional Airport (28 nm NW)

### Nearby radio navigation aids

VOR radial/distance	VOR name	Freq	Var
<a href="#">AUG</a> r211/26.4	AUGUSTA VOR/DME	111.40	18W